

FAIR AND AFFORDABLE HOUSING APPLICATION

VIENNA SENIOR HOUSING APARTMENTS FOR 62+

150 North Street, City of Rye, NY 10580

APPLICATION DEADLINE: SEPTEMBER 8, 2017

Mail or Hand Deliver Application to:

Housing Action Council at 55 South Broadway, Tarrytown, NY 10591

Phone: 914-332-4144

Check whether you are interested in One Bedroom Two Bedroom

Maximum Household Income Limits Apply:

| # of Apartments | AMI % Area Median Income | Rents | Maximum Household Income |
|-----------------|-----------------------------|---------|---|
| 6 One Bedroom | 50% | \$ 995 | 1 person - \$39,000, 2 person - \$44,600 |
| 22 One Bedroom | 60% | \$1,204 | 1 person - \$46,800, 2 person - \$53,520 |
| 2 Two Bedroom | 50% | \$1,198 | 2 person - \$44,600, 3 person - \$50,150 4 person - \$55,700 |
| 10 Two Bedroom | 60% | \$1,449 | 2 person - \$53,520, 3 person - \$60,180 4 person - \$66,840 |

*Rents & Maximum Household Income as of June 2017, Subject to Change.
Heat and Hot Water are included in Rent

1. APPLICANT INFORMATION:

Name: _____

Address: _____ Apt#: _____

City: _____ State: _____ Zip: _____

Home Phone: _____ Cell Phone: _____ Work Phone: _____

SSN: _____ DOB: _____ Gross Income: _____

Email: _____



Housing Action Council



NO SMOKING



EQUAL HOUSING
OPPORTUNITY

6/2017

2. CO-APPLICANT INFORMATION:

Name: _____

Address: _____ Apt#: _____

City: _____ State: _____ Zip: _____

Home Phone: _____ Cell Phone: _____ Work Phone: _____

SSN: _____ DOB: _____ Gross Income: _____

Email: _____

3. LIST ALL PERSONS WHO WILL LIVE WITH YOU, PLEASE START WITH YOURSELF:

| FULL NAME | RELATIONSHIP | DATE OF BIRTH | SEX | ATTENDING SCHOOL |
|--|---------------|-------------------|----------|------------------|
| a. _____ | ____H.O.H____ | _____ | _____ | _____ |
| Social Security #: _____ | | Occupation: _____ | | |
| b. _____ | _____ | _____ | _____ | _____ |
| Social Security #: _____ | | Occupation: _____ | | |
| c. _____ | _____ | _____ | _____ | _____ |
| Social Security #: _____ | | Occupation: _____ | | |
| d. _____ | _____ | _____ | _____ | _____ |
| Social Security #: _____ | | Occupation: _____ | | |
| e. Do you expect any change (s) in your family size? | | _____ YES | _____ NO | |
| If YES , EXPLAIN: _____ | | | | |



Housing Action Council



NO SMOKING



EQUAL HOUSING OPPORTUNITY

6/2017

4. STATISTICAL INFORMATION

a. The following information is required for statistical purposes so that the Department of Housing and Urban Development (HUD) may determine the degree to which its programs are utilized by people of different racial & ethnic backgrounds.

RACIAL GROUP IDENTIFICATION: Used for statistical purposes only. (Please check only one from this group for the head of household only).

Single Race

- White
- Black or African American
- Asian
- American Indian or Alaska Native
- Native Hawaiian or Other Pacific Islander

Multi-Race

- American Indian or Alaska Native & White
- Asian & White
- Black or African American & White
- American Indian or Alaska Native & Black or African American
- Other Multi Racial

b. **ETHNICITY:** (check **only one** from this group) Hispanic Non-Hispanic

5. ACCESSIBILITY/ADAPTABILITY

Do you need a handicapped accessible/adaptable apartment? YES NO

6. RENT:

What is your Current Monthly Rent \$ _____

Check Utilities paid by you now:

- Heat \$ _____ per month
- Electricity \$ _____ per month
- Gas \$ _____ per month
- Water \$ _____ per month
- Other \$ _____ per month

Do you receive Rental Assistance? Yes No If YES, identify source _____



Housing Action Council



NO SMOKING



6/2017

EQUAL HOUSING OPPORTUNITY

7. INCOME:

List **ALL** full-time, part-time, seasonal and/or temporary employment for **ALL** household members. Include overtime pay, commissions, fees, tips, bonuses and/or self-employed earnings.

| HOUSEHOLD MEMBER | EMPLOYER'S NAME/ADDRESS | GROSS EARNINGS (Pre-Tax) | |
|------------------|-------------------------|--|-------------|
| | | CURRENT | ANTICIPATED |
| _____ | _____ | \$ _____ | \$ _____ |
| | | Weekly/ biweekly/ monthly (circle one) | |
| _____ | _____ | \$ _____ | \$ _____ |
| | | Weekly/ biweekly/ monthly (circle one) | |
| _____ | _____ | \$ _____ | \$ _____ |
| | | Weekly/ biweekly/ monthly (circle one) | |
| _____ | _____ | \$ _____ | \$ _____ |
| | | Weekly/ biweekly/ monthly (circle one) | |

8. OTHER SOURCES OF INCOME:

(EXAMPLES: welfare, social security, SSI, pensions, disability compensation, unemployment compensation, interest, baby-sitting, care-giving, alimony, child support, annuities, dividends, income from rental property and/or Armed Forces Reserves.)

| HOUSEHOLD MEMBER | SOURCE | AMOUNT |
|------------------|--------|--|
| _____ | _____ | \$ _____ \$ _____ |
| | | Weekly/ biweekly/ monthly (circle one) |
| _____ | _____ | \$ _____ \$ _____ |
| | | Weekly/ biweekly/ monthly (circle one) |
| _____ | _____ | \$ _____ \$ _____ |
| | | Weekly/ biweekly/ monthly (circle one) |



Housing Action Council



NO SMOKING



EQUAL HOUSING OPPORTUNITY

6/2017

9. HOUSEHOLD ASSETS:

Checking Accounts:

Bank: _____ Acct. No.: _____ Amt.: _____

Bank: _____ Acct. No.: _____ Amt.: _____

Savings Accounts: *(includes Passbook/Statement and Christmas/Vacation Clubs)*

Bank: _____ Acct. No.: _____ Amt.: _____

Bank: _____ Acct. No.: _____ Amt.: _____

Bank: _____ Acct. No.: _____ Amt.: _____

Certificates of Deposit (CD's):

Bank: _____ Acct. No.: _____ Amt.: _____

Bank: _____ Acct. No.: _____ Amt.: _____

Credit Union Shares:

Credit Union Name: _____ Amt.: _____

Address _____

Stocks/Bonds (value): \$ _____ Savings Bonds (value): _____

Other Amt.: *(includes IRA's, mutual funds, etc.)* \$ _____

Does the applicant or co-applicant **NOW** own real estate: _____ YES _____ NO

If "yes", what is the value: _____

Has the applicant or co-applicant **EVER** owned real estate? _____ YES _____ NO

If "yes", when? _____

10. DOCUMENTATION

All household members must submit COPIES of the following documents with their application:

_____ 2016 & 2015 **W2's**

_____ 2016 & 2015 **Federal Tax Returns** with all Schedules

_____ One Month's Most Recent Pay Stubs & documentation on any other source of income, e.g. social security, pension, annuity

_____ 3 Months of all Bank, Credit Union, and Investment Statements (**all pages**)

_____ Most Recent Retirement Fund Account Statements (e.g. 403b, 401k)

_____ Divorce/ Separation Documents, if applicable

_____ Driver's License for any household member 18+, Birth Certificates for all household members, Resident card if applicable



Housing Action Council



NO SMOKING



EQUAL HOUSING OPPORTUNITY

6/2017

I DECLARE THAT THE STATEMENTS CONTAINED IN THIS APPLICATION ARE TRUE AND COMPLETE TO THE BEST OF MY KNOWLEDGE. WARNING: WILLFUL FALSE STATEMENTS OR MISREPRESENTATIONS ARE A CRIMINAL OFFENSE.

Applicant Signature

Date

Co-Applicant Signature

Date

CONSUMER CREDIT INFORMATION

I/ We hereby authorize Housing Action Council or North St. Senior LLC and/ or Arco Management Corporation to use any consumer reporting agency, credit bureau or other investigative agencies employed by such, to investigate references, or statements or other data obtained from me or from any person pertaining to my employment history, credit, prior tenancies, character, general reputation, personal characteristics and mode of living, to obtain a consumer report and such other credit information which may result thereby, and to disclose and furnish such information to Housing Action Council, to the owner, its agents and to agencies that made or will make funding available in connection with this property listed above in support of this application. I have been advised that I have the right, under 606B of the Fair Credit Reporting Act, to make a written request, within reasonable time, for a complete and accurate disclosure of the nature and scope of any investigation.

Applicant Signature

Co-Applicant Signature

Date

11. HOW DID YOU HEAR ABOUT THIS DEVELOPMENT?

- Friend If friend, how did your friend hear about this? _____
- Employer
- Sign Posted on Site
- Website/ Internet _____ (list site)
- Newspaper (Identity): _____ On-line Version? _____
- Church/ Synagogue (Identify): _____
- Community Organization (Identify): _____
- Other (Identify): _____

Note:

1. Only one (1) application per household. If your name appears on more than one application you will be disqualified and the application will not be considered.
2. Applications must be signed in all requested places.
3. Applications must be returned by mail or hand delivered with supporting documentation.
4. No payment should be given to anyone in connection with the preparation or filing of this application



Housing Action Council



NO SMOKING



EQUAL HOUSING OPPORTUNITY

6/2017

1 Bedroom – 800 sq. ft. +/-
Floor Plan – For Illustrative Purposes
Vienna Senior Housing

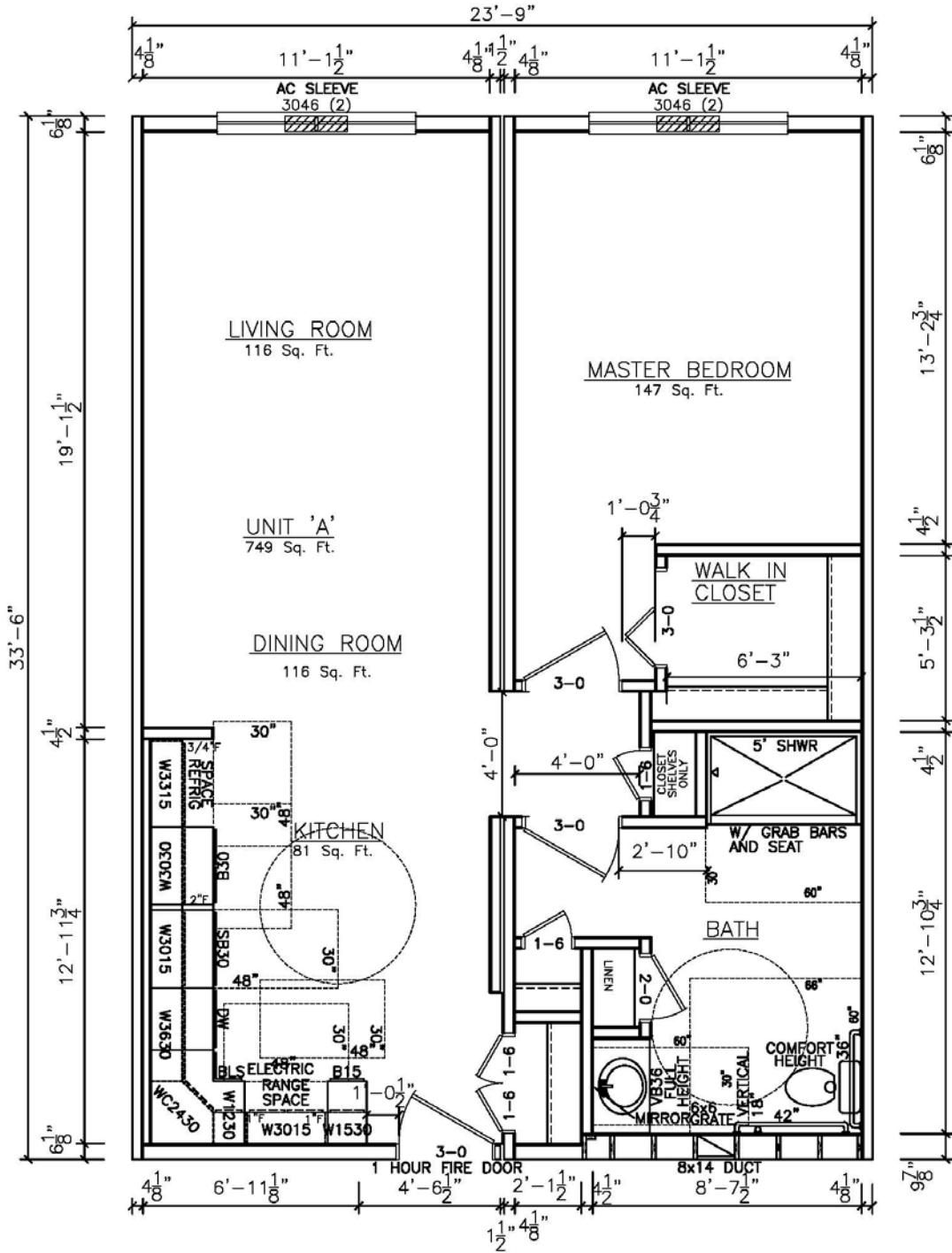

Housing Action Council



NO SMOKING



EQUAL HOUSING OPPORTUNITY

6/2017

**2 Bedroom – 930 sq. ft. +/-
Floor Plan – For Illustrative Purposes
Vienna Senior Housing**

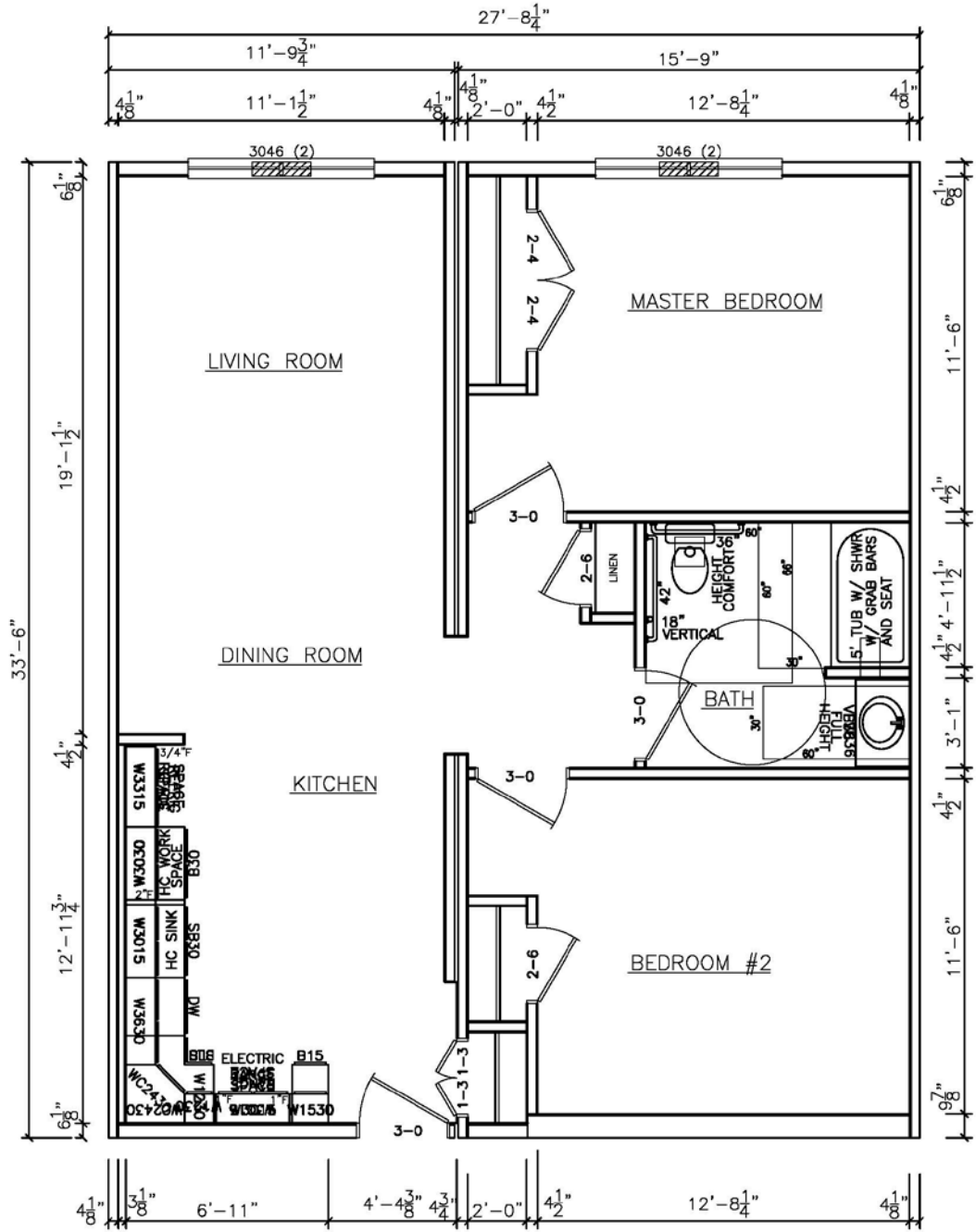

Housing Action Council



NO SMOKING



EQUAL HOUSING OPPORTUNITY

6/2017